

BULLS COMMUNITY CENTRE

SITE INFORMATION

Site Address: 110 Bridge Street, Bulls, Rangitikei

Exposure Zone: Zone C

Wind Zone: High (as per 3604)

Land Parcels: TBC

Importance Level: 3

SURVEY DATA

Site Plan based on Topographic Survey completed by A&C Surveys Ltd Ph 06 347 8586 Dated 07.02.2017

BRIDGE STREET SH1

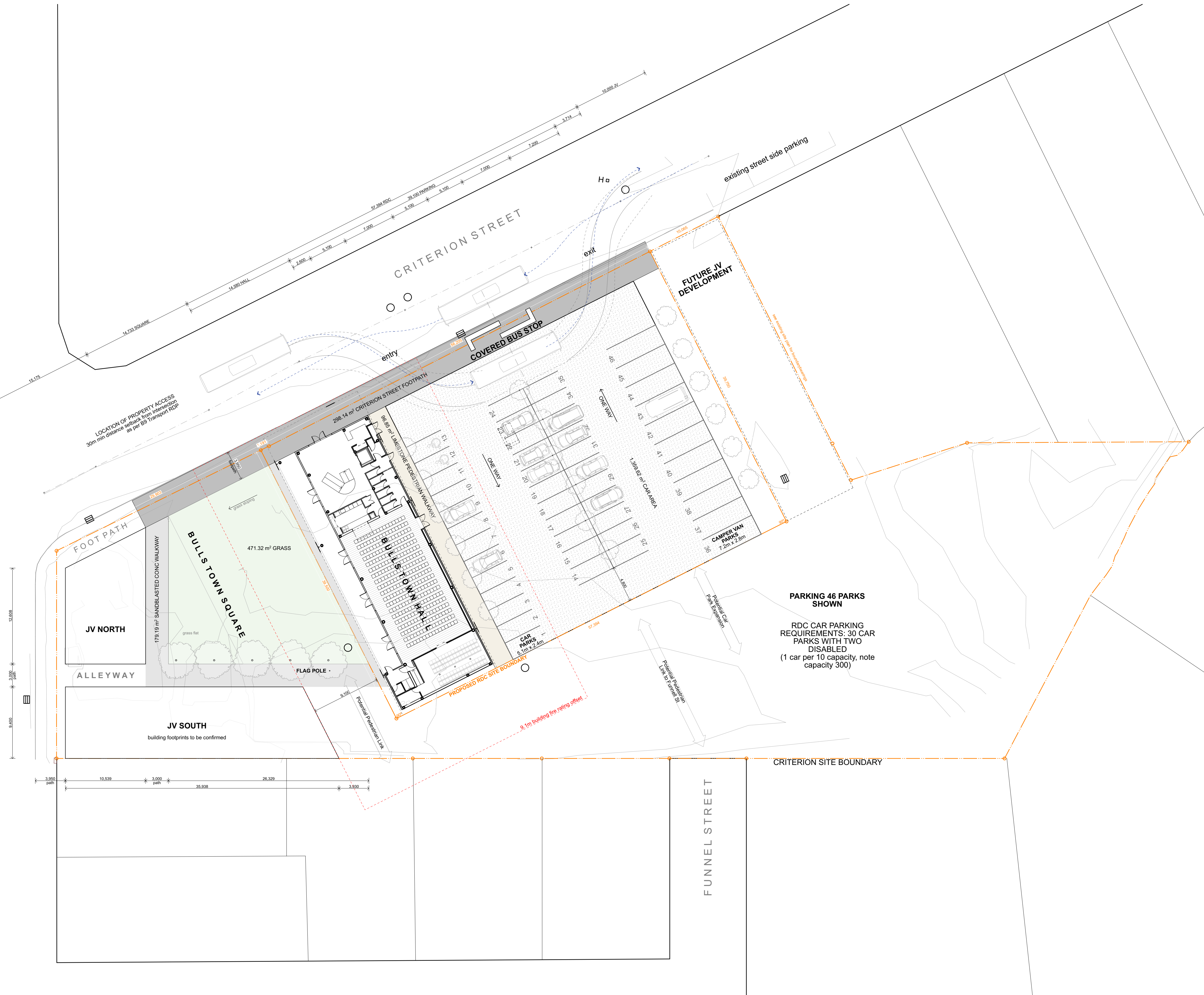

PARKING 46 PARKS SHOWN
 RDC CAR PARKING REQUIREMENTS: 30 CAR PARKS WITH TWO DISABLED (1 car per 10 capacity, note capacity 300)

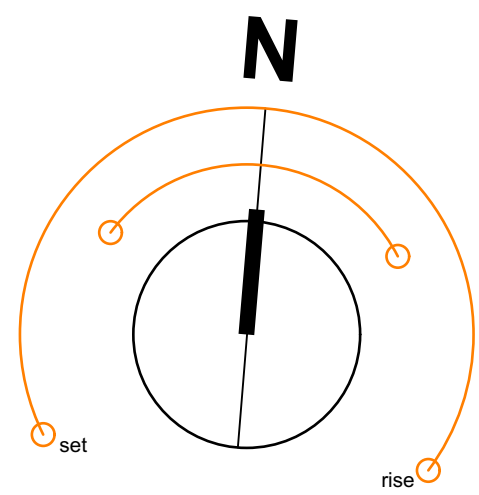

Bulls Community Centre for RDC

CHECKED	ENG	SER	AWL	CLT	REVISION	DATE	PURPOSE
						02/03/17	V5 DD VM Issue
						22/08/16	V4 Issue RDC V4 for fund application
						01/09/16	V3 PD Issue
						29/07/16	V2 Issued QS for PD pricing
						30/01/15	V1 Issued QS for CD pricing

ARCHITECTURE WORKSHOP

Architecture Workshop Ltd
 P.O. Box 9572 Wellington New Zealand
 Tel (04) 473 4438 Fax (04) 473 9572
 email@archwks.co.nz

Copyright of this drawing remains vested with Architecture Workshop Ltd
 Contractor to check carefully all dimensions on site

Proposed Site Plan
Scale 1:250 at A1
3/03/17
GA01.2

A1 ORIGINAL